

ET-SE01

00001	Steuereinheit	control units	besturingseenheid
	74 210 Heißwasserbegrenzung/Steuereinheit	hot water safety stop/control units	heetwaterbegrenzing/besturingseenheid
	74 386 Heißwasserbegrenzung/Steuereinheit	hot water safety stop/control units	heetwaterbegrenzing/besturingseenheid
	75 032 Kartusche, KLUDI MIDI-MIX	cartridge, KLUDI MIDI-MIX	cartouche, KLUDI MIDI-MIX
	75 201 Kartusche	cartridge	cartouche
	75 605 Kartusche	cartridge	cartouche
	75 898 Kartusche, KLUDI MEDI-CARE	cartridge, KLUDI MEDI-CARE	cartouche, KLUDI MEDI-CARE
	76 400 Kartusche, ECO-Plus	cartridge, ECO-Plus	cartouche, ECO-Plus
	76 619 Steuereinheit	control units	besturingseenheid
	76 856 Kartusche	cartridge	cartouche
	76 941 Kartusche, KLUDI MEDI-CARE	cartridge, KLUDI MEDI-CARE	cartouche, KLUDI MEDI-CARE
	76 969 Steuereinheit K402	cartridge K402	cartouche K402

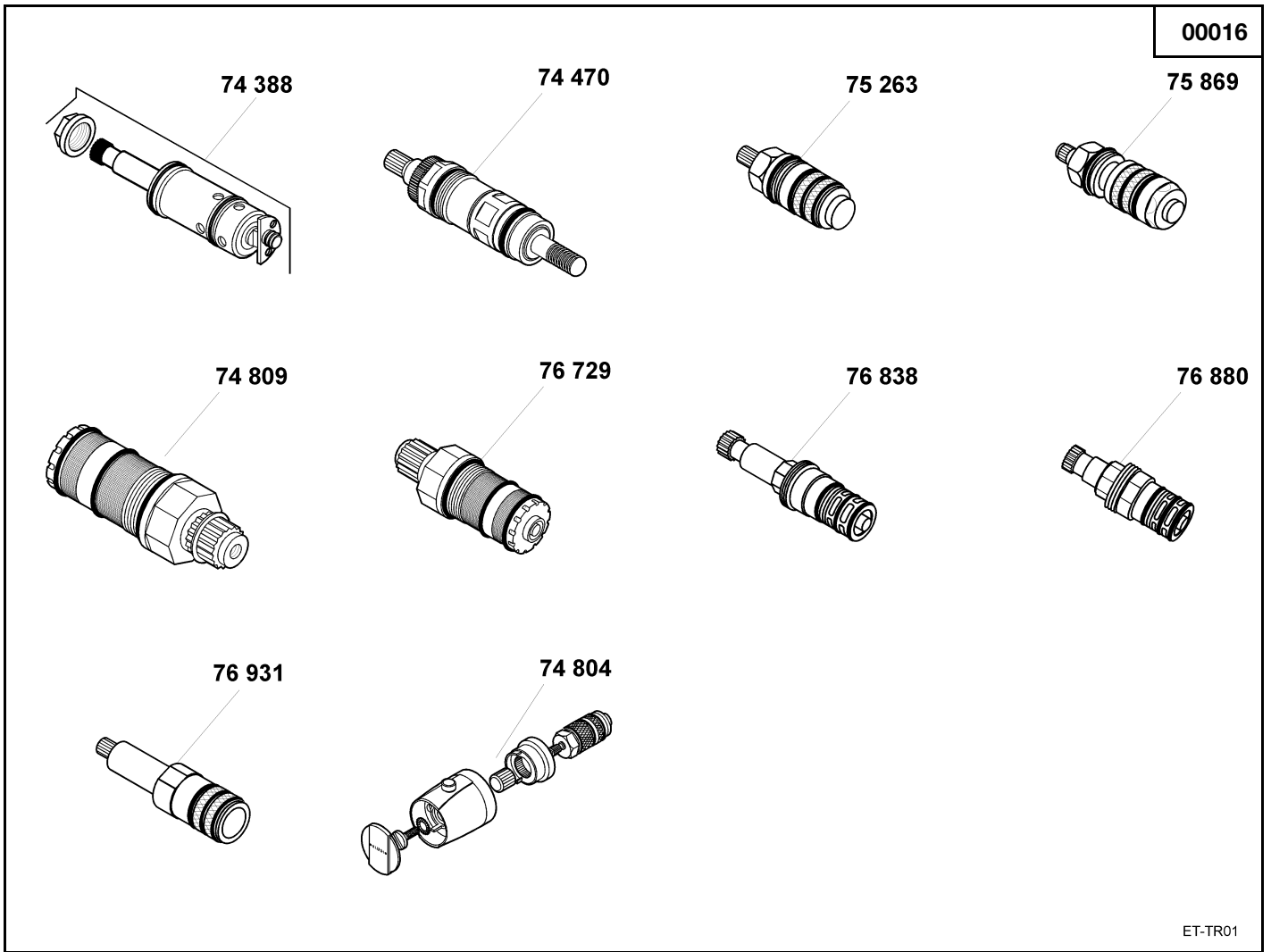

00016	Temperaturregeleinheit	temperature control valve	temperatuurregeleenheid
74 388	Temperaturregeleinheit	temperature control valve	temperatuurregeleenheid
74 470	Temperaturregeleinheit	temperature control valve	temperatuurregeleenheid
74 804	Temperaturregeleinheit	temperature control valve	temperatuurregeleenheid
74 809	Temperaturregeleinheit	temperature control valve	temperatuurregeleenheid
75 263	Temperaturregeleinheit	temperature control valve	temperatuurregeleenheid
75 869	Temperaturregeleinheit	temperature control valve	temperatuurregeleenheid
76 729	Temperaturregeleinheit	temperature control valve	temperatuurregeleenheid
76 838	Temperaturregeleinheit	temperature control valve	temperatuurregeleenheid
76 880	Temperaturregeleinheit	temperature control valve	temperatuurregeleenheid
76 931	Temperaturregeleinheit	temperature control valve	temperatuurregeleenheid

00008

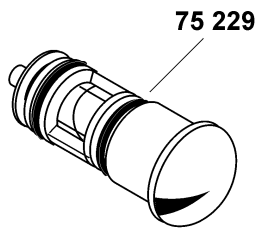

75 229

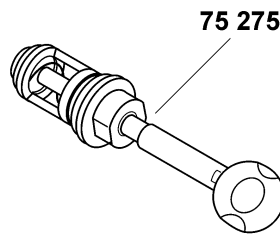

75 275

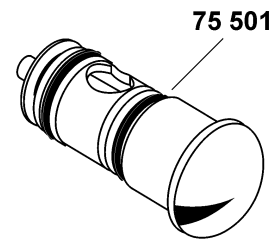

75 501

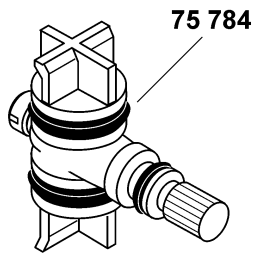

75 784

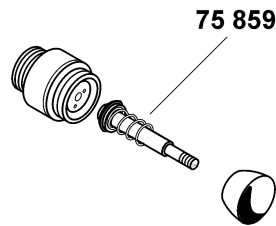

75 859

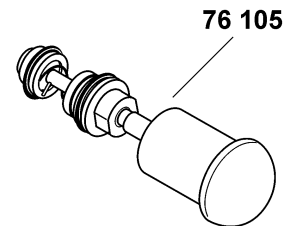

76 105

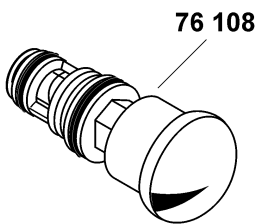

76 108

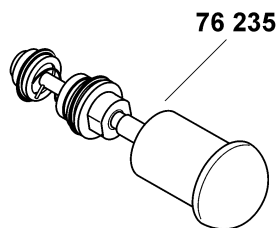

76 235

ET-UM01

00008

Umstellung

diverter

omstelling

75 229 autom. Umstellung AP-Armaturen
 75 275 autom. Umstellung UP-Armaturen
 75 501 autom. Umstellung
 75 784 Umstellung zu 26101/26209
 75 859 autom. Umstellung KLUDI LOGO MIX
 76 105 autom. UP-Umstellung
 76 108 autom. Umstellung
 76 235 autom. UP-Umstellung KLUDI EVITA

automatic diverter, wall mounted
 automatic diverter, concealed
 automatic diverter
 diverter for 26101/26209
 automatic diverter KLUDI LOGO MIX
 automatic diverter, concealed
 automatic diverter
 automatic diverter KLUDI EVITA,
 concealed

autom. omstelling voor opb.mengkranen
 autom. omstelling voor inb.mengkranen
 automatische omstelling
 omstelling voor 26101/26209
 autom. omstelling KLUDI LOGO MIX
 autom. omstelling inbouw
 automatische omstelling
 autom. omstelling inbouw, KLUDI EVITA

Einzelteile / spare parts / onderdelen

000081

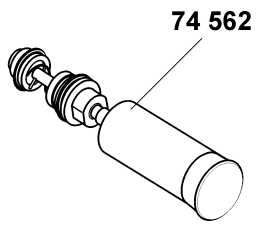

74 562

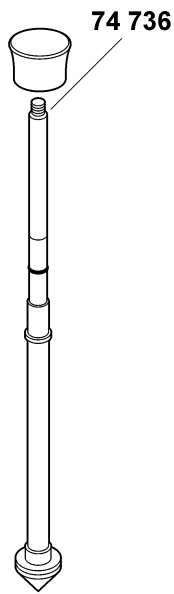

74 736

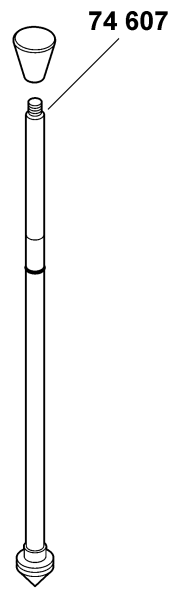

74 607

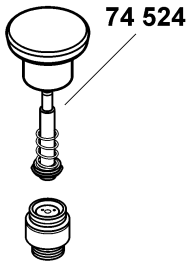

74 524

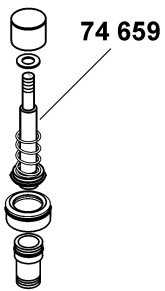

74 659

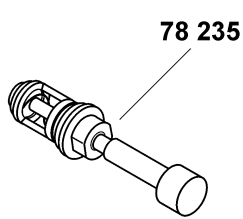

78 235

ET-UM02

000081	Umstellung	diverter	omstelling
74 562	Umstellung	diverter	omstelling
74 607	Umstellung, kpl.	diverter complete	omstelling compleet
74 659	Umstellung	diverter	omstelling
74 736	Umstellung, kpl.	diverter complete	omstelling compleet
75 524	Gussauslauf	cased spout	gegoten uitloop
78 235	autom. Umstellung	automatic diverter	automatische omstelling

000082

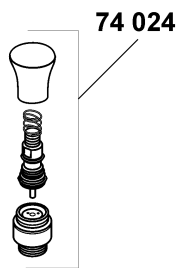

74 024

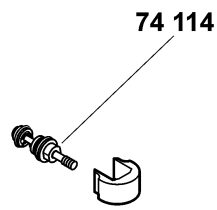

74 114

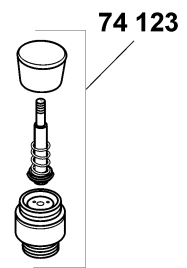

74 123

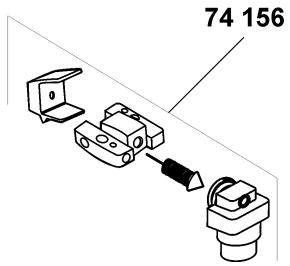

74 156

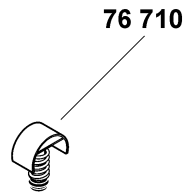

76 710

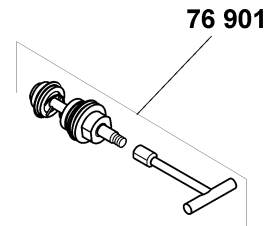

76 901

ET-UM03

000082	Umstellung	diverter	omstelling
74 024	Umstellung	diverter	omstelling
74 114	Umstellung	diverter	omstelling
74 123	autom. Umstellung	automatic diverter	automatische omstelling
74 156	Umstellung	diverter	omstelling
76 710	Umstellung	diverter	omstelling
76 901	Umstellung	diverter	omstelling

000083

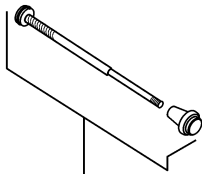

75 004 → 09/02

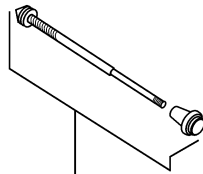

74 113 10/02 →

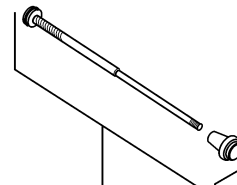

75 066 → 09/02

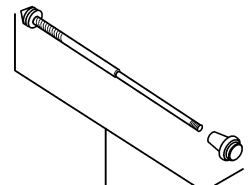

74 006 10/02 →

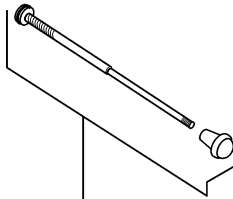

76 544 → 09/02

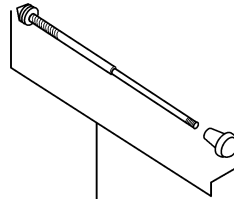

74 039 10/02 →

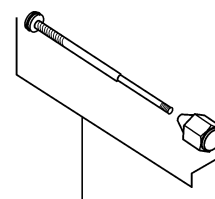

76 688 → 09/02

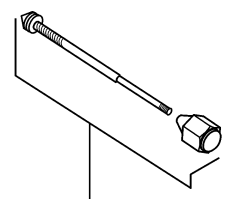

74 007 10/02 →

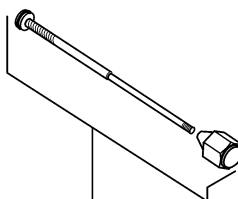

76 732 → 09/02

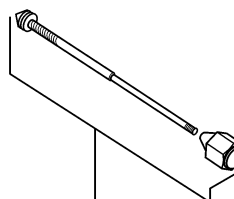

74 008 10/02 →

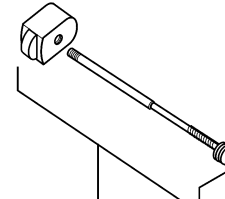

74 261

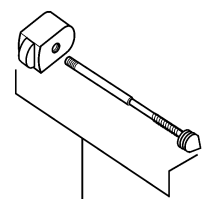

74 263

ET-UM04

000083	Umstellung	diverter	omstelling
	74 006 Umstellung, KLUDI PAMELA	diverter, KLUDI PAMELA	omstelling, KLUDI PAMELA
	74 007 Umstellung, KLUDI ADLON	diverter, KLUDI ADLON	omstelling, KLUDI ADLON
	74 008 Umstellung, KLUDI ADLON	diverter, KLUDI ADLON	omstelling, KLUDI ADLON
	74 039 Umstellung, KLUDI AMBIENTA	diverter, KLUDI AMBIENTA	omstelling, KLUDI AMBIENTA
	74 113 Umstellung, KLUDI PAMELA	diverter, KLUDI PAMELA	omstelling, KLUDI PAMELA
	74 261 Umstellung, JOOP!	diverter, JOOP!	omstelling, JOOP!
	74 263 Umstellung, JOOP!	diverter, JOOP!	omstelling, JOOP!
	75 004 Umstellung, KLUDI PAMELA	diverter, KLUDI PAMELA	omstelling, KLUDI PAMELA
	75 066 Umstellung, KLUDI PAMELA	diverter, KLUDI PAMELA	omstelling, KLUDI PAMELA
	76 544 Umstellung, KLUDI AMBIENTA	diverter, KLUDI AMBIENTA	omstelling, KLUDI AMBIENTA
	76 688 Umstellung, KLUDI ADLON	diverter, KLUDI ADLON	omstelling, KLUDI ADLON
	76 732 Umstellung, KLUDI ADLON	diverter, KLUDI ADLON	omstelling, KLUDI ADLON

000084

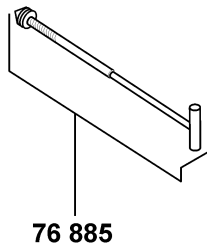
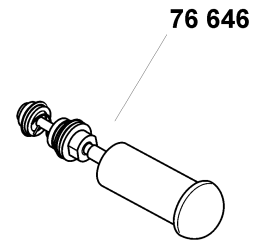
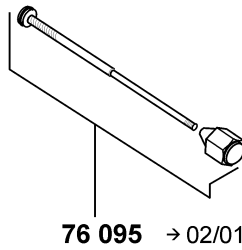
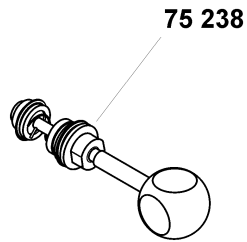
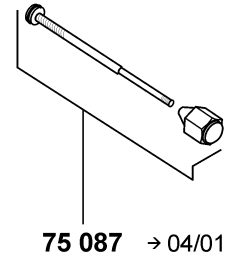
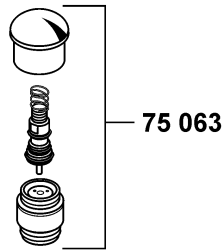
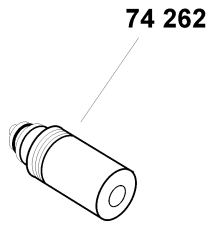

ET-UM05

000084	Umstellung	diverter	omstelling
74 262	Umstellung	diverter	omstelling
75 063	Umstellung	diverter	omstelling
75 087	Umstellung, KLUDI ADLON	diverter, KLUDI ADLON	omstelling, KLUDI ADLON
75 238	autom. Umstellung	automatic diverter	automatische omstelling
76 095	Umstellung, KLUDI ADLON	diverter, KLUDI ADLON	omstelling, KLUDI ADLON
76 646	autom. UP-Umstellung KLUDI FLAIR	automatic diverter KLUDI FLAIR, concealed	autom. omstelling inbouw, KLUDI FLAIR
76 885	Umstellung, KLUDI NEW WAVES	diverter, KLUDI NEW WAVES	omstelling, KLUDI NEW WAVES

Einzelteile / spare parts / onderdelen

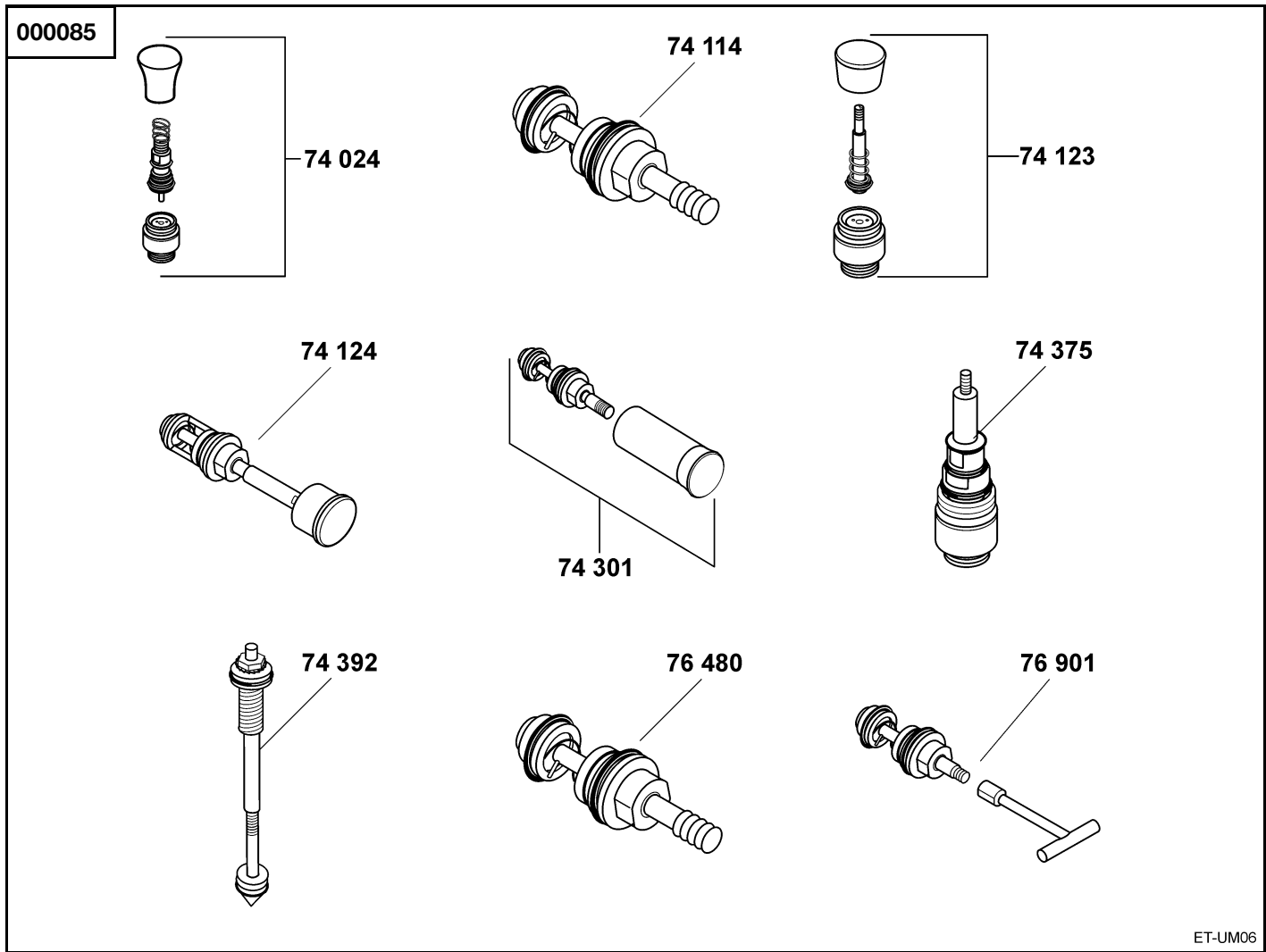

ET-UM06

000085	Umstellung	diverter	omstelling
	74 024 Umstellung	diverter	omstelling
	74 114 Umstellung	diverter	omstelling
	74 123 autom. Umstellung	automatic diverter	automatische omstelling
	74 124 autom. Umstellung UP-Armaturen	automatic diverter, concealed	autom. omstelling voor inb.mengkranen
	74 301 Umstellung	diverter	omstelling
	74 375 Umstellung	diverter	omstelling
	74 392 Umstellung	diverter	omstelling
	76 480 Umstellung	diverter	omstelling
	76 901 Umstellung	diverter	omstelling

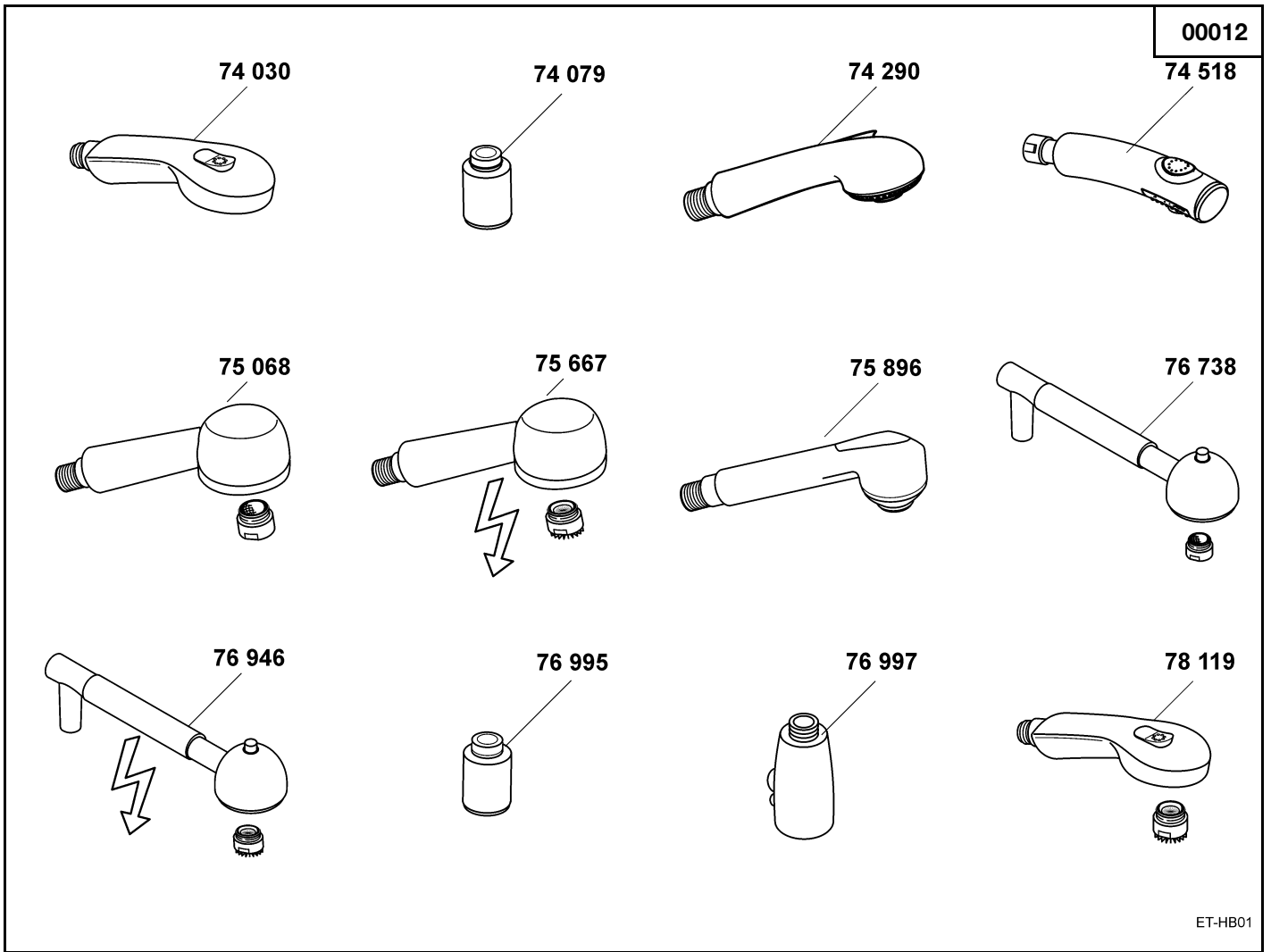

ET-HB01

00012	Handbrause	handshower	handdouche
74 030	Handbrause	handshower	handdouche
74 079	Handstück	hand knob	neusstuk
74 290	Handbrause	handshower	handdouche
74 518	Handbrause	handshower	handdouche
75 068	Handbrause KLUDI MIX/KLUDI SWINGLINE	handshower KLUDI MIX/KLUDI SWINGLINE	handdouche KLUDI MIX/KLUDI SWINGLINE
75 667	Handbrause KLUDI MIX/KLUDI SWINGLINE ND	handshower KLUDI MIX/KLUDI SWINGLINE ND	handdouche KLUDI MIX/KLUDI SWINGLINE LD
75 896	Handbrause	handshower	handdouche
76 738	Handbrause	handshower	handdouche
76 946	Handbrause	handshower	handdouche
76 995	Brausekopf	shower rose	douchekop
76 997	Brausekopf	shower rose	douchekop
78 119	Handbrause	handshower	handdouche

00002

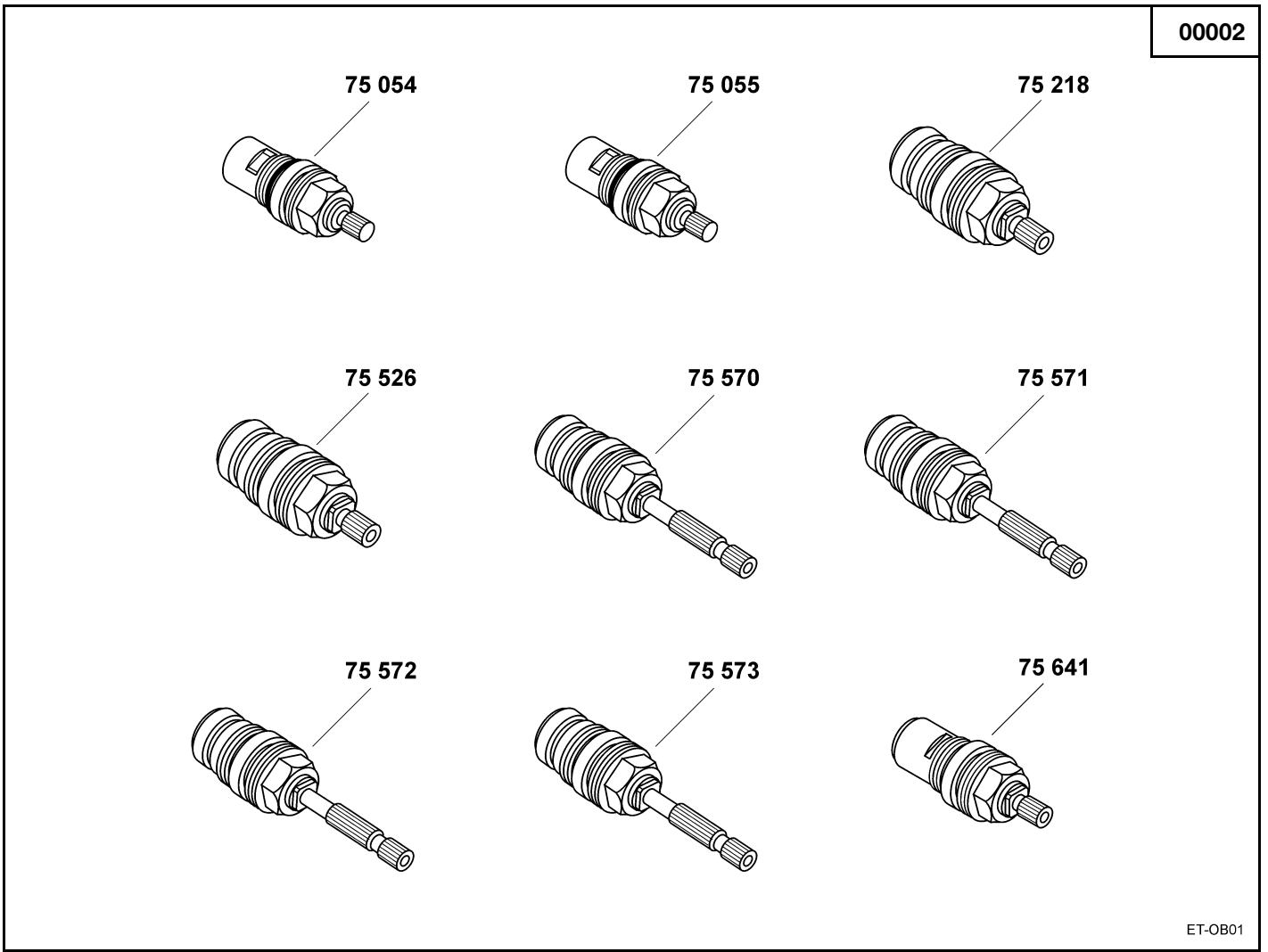

ET-OB01

00002	Oberteil	upper valve diameter	bovendeeel
	75 054 Keramik-Oberteil G 1/2, 90°	ceramic headpart G 1/2, 90°	keramisch bovendeeel G 1/2, 90°
	75 055 Keramik-Oberteil G 1/2, 90°	ceramic headpart G 1/2, 90°	keramisch bovendeeel G 1/2, 90°
	75 218 Klassisches-Oberteil G 1/2	standard compression valve G 1/2	traditioneel bovendeeel G 1/2
	75 526 Klassisches-Oberteil G 3/8	standard compression valve G 3/8	traditioneel bovendeeel G 3/8
	75 570 Klassisches-Oberteil G 1/2	standard compression valve G 1/2	traditioneel bovendeeel G 1/2
	75 571 Klassisches-Oberteil G 3/4	standard compression valve G 3/4	traditioneel bovendeeel G 3/4
	75 572 Klassisches-Oberteil G 1	standard compression valve G 1	traditioneel bovendeeel G 1
	75 573 Klassisches-Oberteil G 1 1/4	standard compression valve G 1 1/4	traditioneel bovendeeel G 1 1/4
	75 641 Keramik-Oberteil G 1/2, 180°	ceramic headpart G 1/2, 180°	keramisch bovendeeel G 1/2, 180°

Einzelteile / spare parts / onderdelen

000021

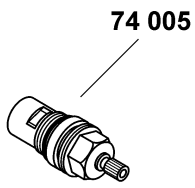

74 005

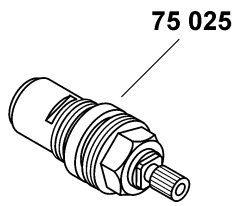

75 025

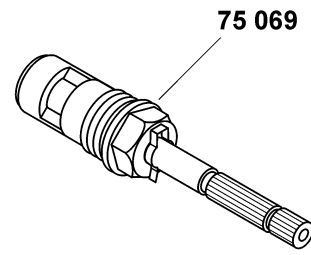

75 069

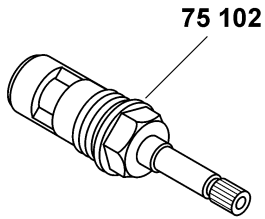

75 102

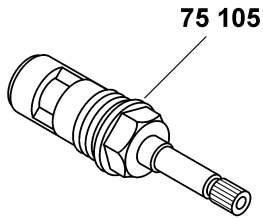

75 105

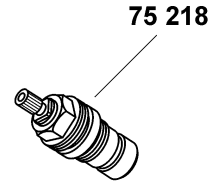

75 218



75 222

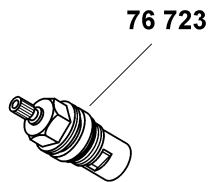

76 723

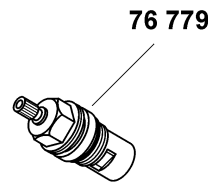

76 779

ET-OB02

000021	Oberteil	upper valve diameter	bovendeel
	74 005 Keramik-Oberteil G 1/2, 90°	ceramic headpart G 1/2, 90°	keramisch bovendeel G 1/2, 90°
	75 025 Keramik-Oberteil G 1/2, 180°	ceramic headpart G 1/2, 180°	keramisch bovendeel G 1/2, 180°
	75 069 Keramik-Oberteil G 3/4, 90°	ceramic headpart G 3/4, 90°	keramisch bovendeel G 3/4, 90°
	75 102 Keramik-Oberteil G 1/2, 180°	ceramic headpart G 1/2, 180°	keramisch bovendeel G 1/2, 180°
	75 105 Keramik-Oberteil G 1/2, 90°	ceramic headpart G 1/2, 90°	keramisch bovendeel G 1/2, 90°
	75 218 Klassisches-Oberteil G 1/2	standard compression valve G 1/2	traditioneel bovendeel G 1/2
	75 222 Multi-Oberteil	Multi-valve	Multi bovendeel
	76 723 Keramik-Oberteil 180°	ceramic headpart 180°	keramisch bovendeel 180°
	76 779 Keramik-Oberteil G 1/2, 90°	ceramic headpart G 1/2, 90°	keramisch bovendeel G 1/2, 90°

000022

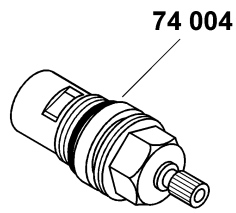

74 004

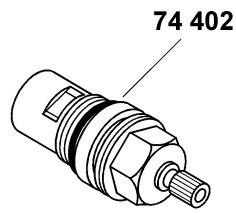

74 402

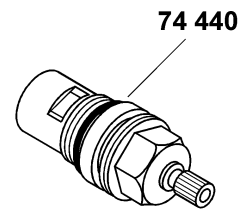

74 440

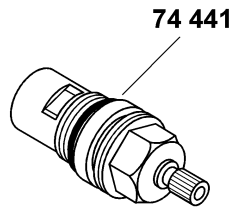

74 441

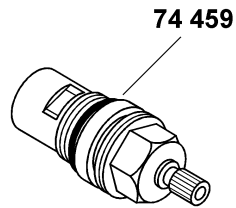

74 459

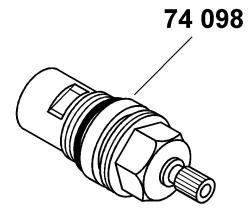

74 098

ET-OB03

000022

Oberteil

upper valve diameter

bovendeel

74 004 Keramik-Oberteil G 3/4, 90°

ceramic headpart G 3/4, 90°

keramisch bovendeel G 3/4, 90°

74 098 Keramik-Oberteil G 1/2, 180°

ceramic headpart G 1/2, 180°

keramisch bovendeel G 1/2, 180°

74 402 Keramik-Oberteil G 3/4, 90°,
entzinkungsarmes Messing

ceramic headpart G 3/4, 90°, copper
dezincification resistance

keramisch bovendeel G 3/4, 90°, ontzinkt
messing

74 440 Keramik-Oberteil rechtsschließend

ceramic-cartridge right-closing

keramisch bovendeel rechtssluitend

74 441 Keramik-Oberteil linksschließend

ceramic-cartridge left-closing

keramisch bovendeel linkssluitend

74 459 Keramik-Oberteil G 1/2, 90°,
entzinkungsarmes Messing

ceramic headpart G 1/2, 90°, copper
dezincification resistance

keramisch bovendeel G 1/2, 90°, ontzinkt
messing